

2008

Aruba[®] LITE

BY STARCRAFT

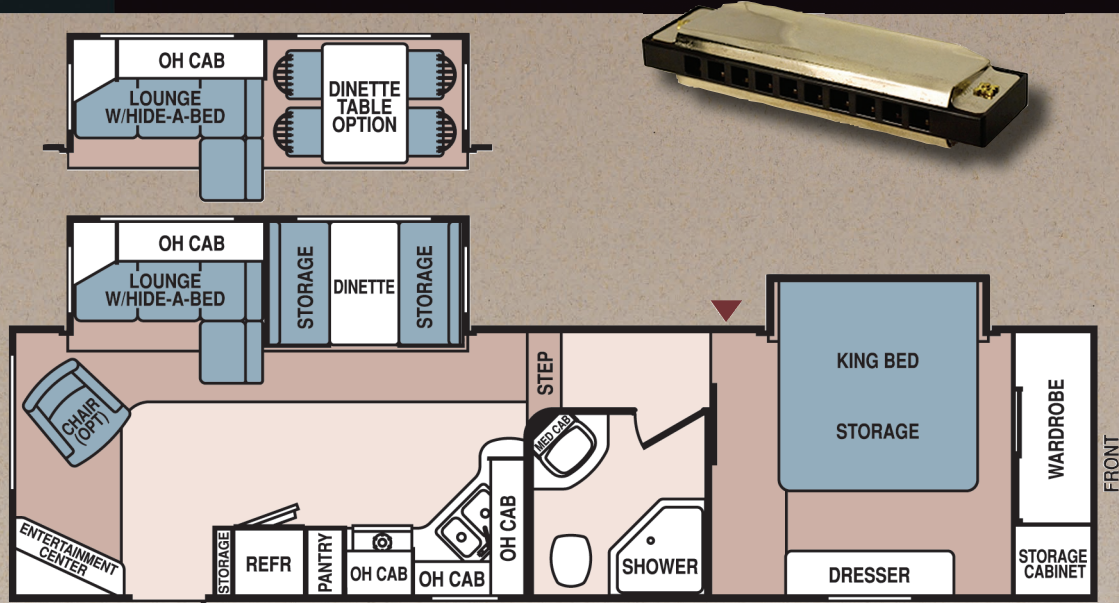

295RLSS

LEGEND: COMFORT AREAS VINYL CARPET STORAGE

WEIGHTS, MEASUREMENTS & CAPACITIES

GVWR (gross vehicle weight rating - lbs.).....	11500	Floor Ducted Furnace w/Electronic Ignition	35M BTU
UVW (unloaded vehicle weight - approx. lbs.).....	8590	6-Gallon LP Water Heater w/Bypass	X
HW (hitch weight - approx. lbs.).....	1974	Freshwater System w/12-Volt Quiet Pump - Includes Water Heater (approx.).....	48 gal.
CCC (cargo carrying capacity - approx. lbs.)	2450	Gray/Black Holding Tanks (approx.)	38-38/38 gal.
Overall Length (add 11" for opt. spare tire & carrier) - Center of Pin to Bumper.....	32' 11"	Double 30# LP Tanks w/Auto Regulator (enclosed).....	X
Body Width.....	8' 0"	45-AMP Power Center w/Battery Charger	X
Upper Deck Interior Ceiling Height	6' 3"	Straight Axles w/All-Wheel Electric Brakes	2
Overall Exterior Height (add 8" for opt. A/C)	11' 8"	Sleeping Capacity	6
Radial Tire Size	ST225/75R 15D		

OPTIONS

- Camelot Green w/Harmony White Décor
- Spring Blue w/Harmony White Décor
- Sand w/Harmony White Décor
- Convenience Package: Monitor Panel, Double-Door Dometic[®] Refrigerator, Dometic[®] Microwave, Double Sink Cover, TV Antenna, Security Light, Equa-Flex[™] Flexible Equalizers
- Program Package: A&E Systems Awning, Spare Tire w/Cover & Carrier, Home Theatre System w/Remote & Outside Speakers, Skylight over Shower in Bath
- Comfort Package: Décor Pillows, Gas/Electric DSI Water Heater, Clock, Raised Refrigerator Panels
- Arctic Package: Enclosed and Heated Underbelly, Flexfoil[®] Insulation in Roof and Underbelly, Arctic Package Decal
- Glass Shower Enclosure
- Carryout Gas Grill
- Ducted 15M-BTU Duo-Therm[™] Air Conditioner
- Freestanding Table w/4 Chairs
- Aluminum Wheels
- Tinted Safety Glass Windows
- Thermopane Safety Glass Windows
- Power Hitch Jacks
- Clip-On Bumper Cover
- Roof Ladder
- 19" LCD TV (Bedroom)
- 32" LCD TV (Living Area)
- Outside Shower
- Skylight in Living Area
- Slideout Toppers
- Electric Awning in Lieu of Manual Awning
- Luxury Value Package: 22" Range w/Cover, Quick Release Landing Legs, Upgrade Dometic[®] Refrigerator RM2862 (8 cu. ft.), China Foot Flush Toilet, Super Lube Axles, Black Tank Flush System, Exterior Cable Hook-Up, Vented End Windows in Living Area Slideout, Pleated Night Shades, Lambrequins in Living Area, Large Pot and Pan Drawer, Hair Dryer
- Swivel Rocker
- CSA (Canadian Standards Association)

WARRANTY INFORMATION*

- 1-Year Hitch-to-Bumper
- 12-Year Roof Covering
- 2- and/or 3-Year Appliances

*Refer to Actual Warranty Information for Details.

©2007 Starcraft RV, Inc. • P.O. Box 458 • Topeka, IN 46571 • (260) 593-2550
www.starcraftrv.com

Due to constant product improvements, Starcraft RV, Inc., reserves the right to make changes, including (but not limited to) equipment, accessories, colors and prices without further notice or obligation. Some equipment shown separately, or on product illustrated, may be optional at extra cost.